



SECOND FLOOR



FIRST FLOOR

COLOR LEGEND

- Administration
- Community / Shared
- Classroom
- Special Education
- Science
- CTC Integrated
- CTC Public
- CTC Service
- CTC Stand Alone
- Mechanical
- Storage
- Support
- Toilet Rooms
- Circulation
- Learning Commons

	New	Renovation
Ground Floor	-	12,810 sf
First Floor	- 148,086 sf	45,524 sf
Second Floor	- 79,814 sf	7,590 sf
Animal Science -	6,500	2000 sf
Total	- 300,142 sf	
Net To Gross	- 1.40	

Reno Add Option - 2B
Dover HS / CTC
 Dover, NH
 UPDATED 05/06/2015



GROUND FLOOR

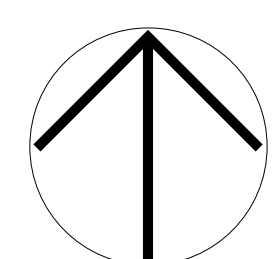

HMFH Architects Inc.

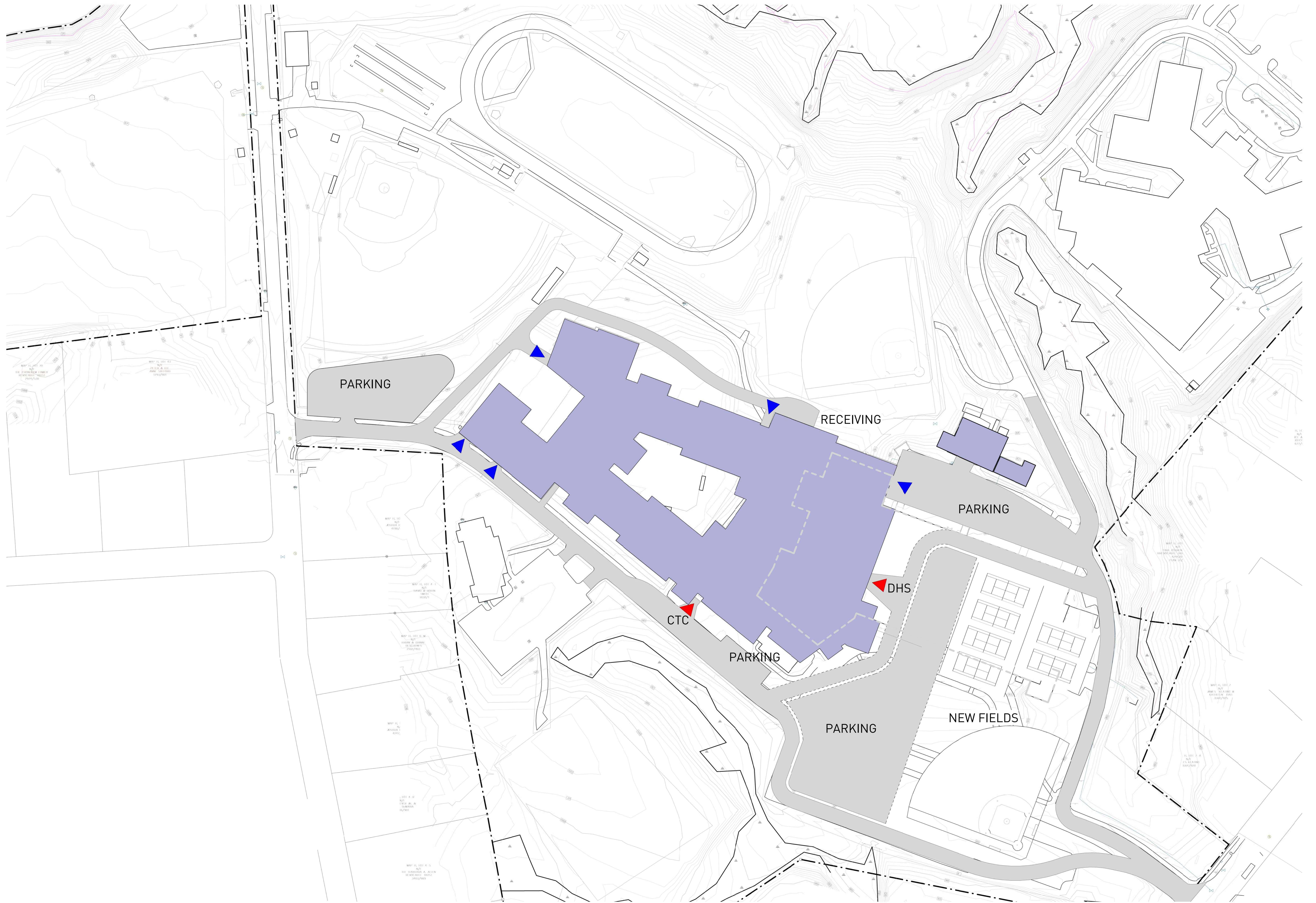

Reno Add Option 2B - Site Plan
Dover HS / CTC
 Dover, NH
 UPDATED 05/06/2015

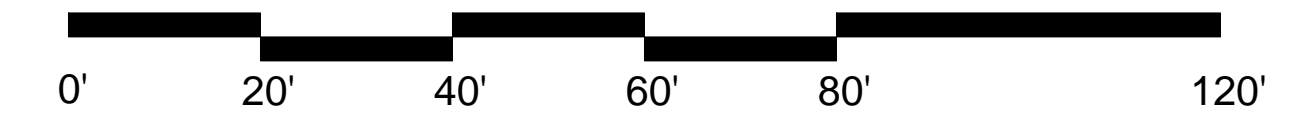
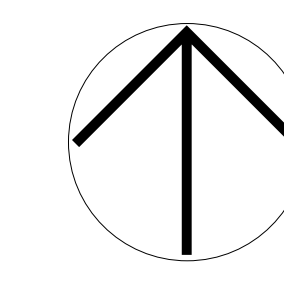

HMFH Architects Inc.

C:\Users\jw\Documents\2015 - Local Revit Files\Dover HS - CTC\2015_05_06.ctb

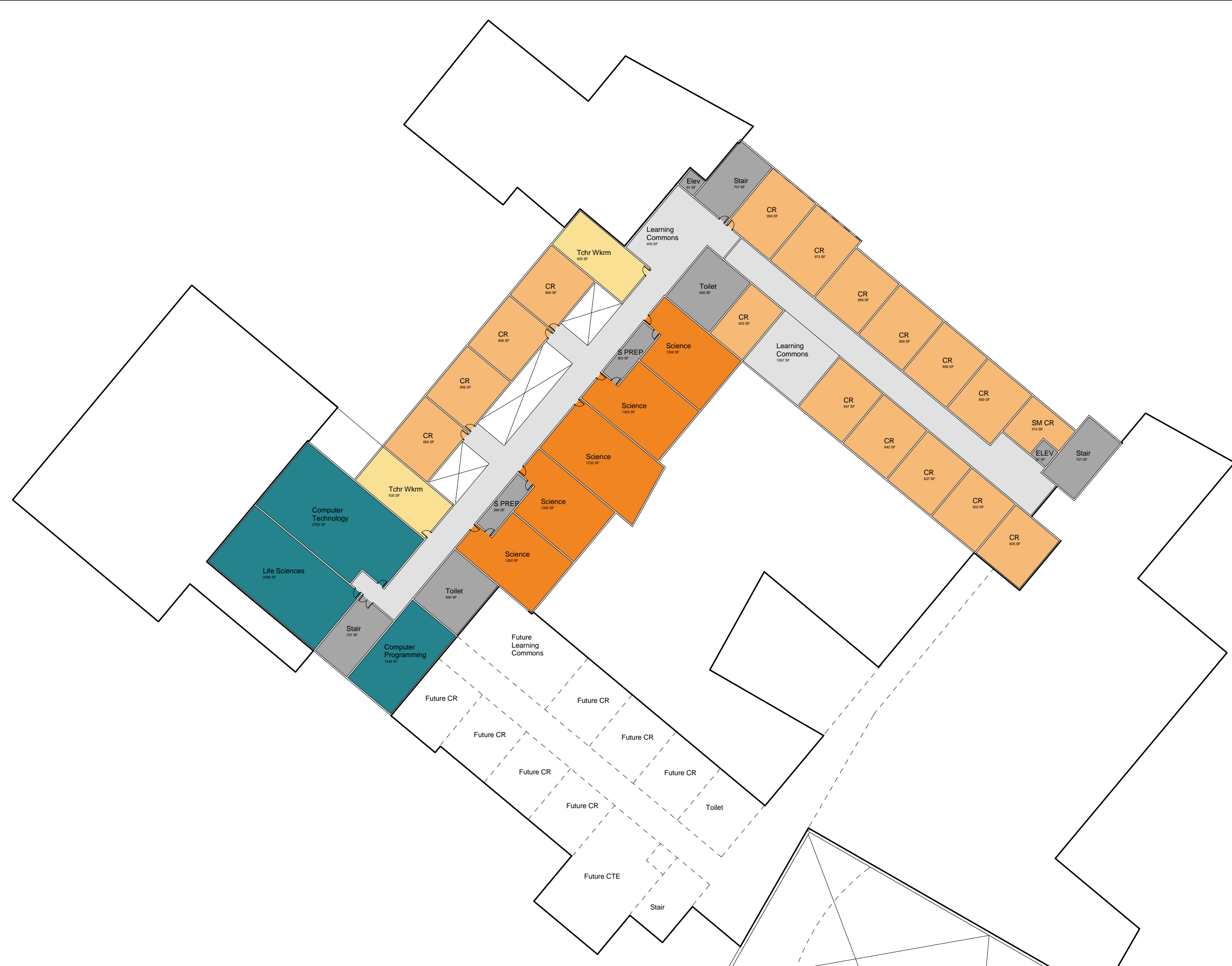

THIRD FLOOR



SECOND FLOOR

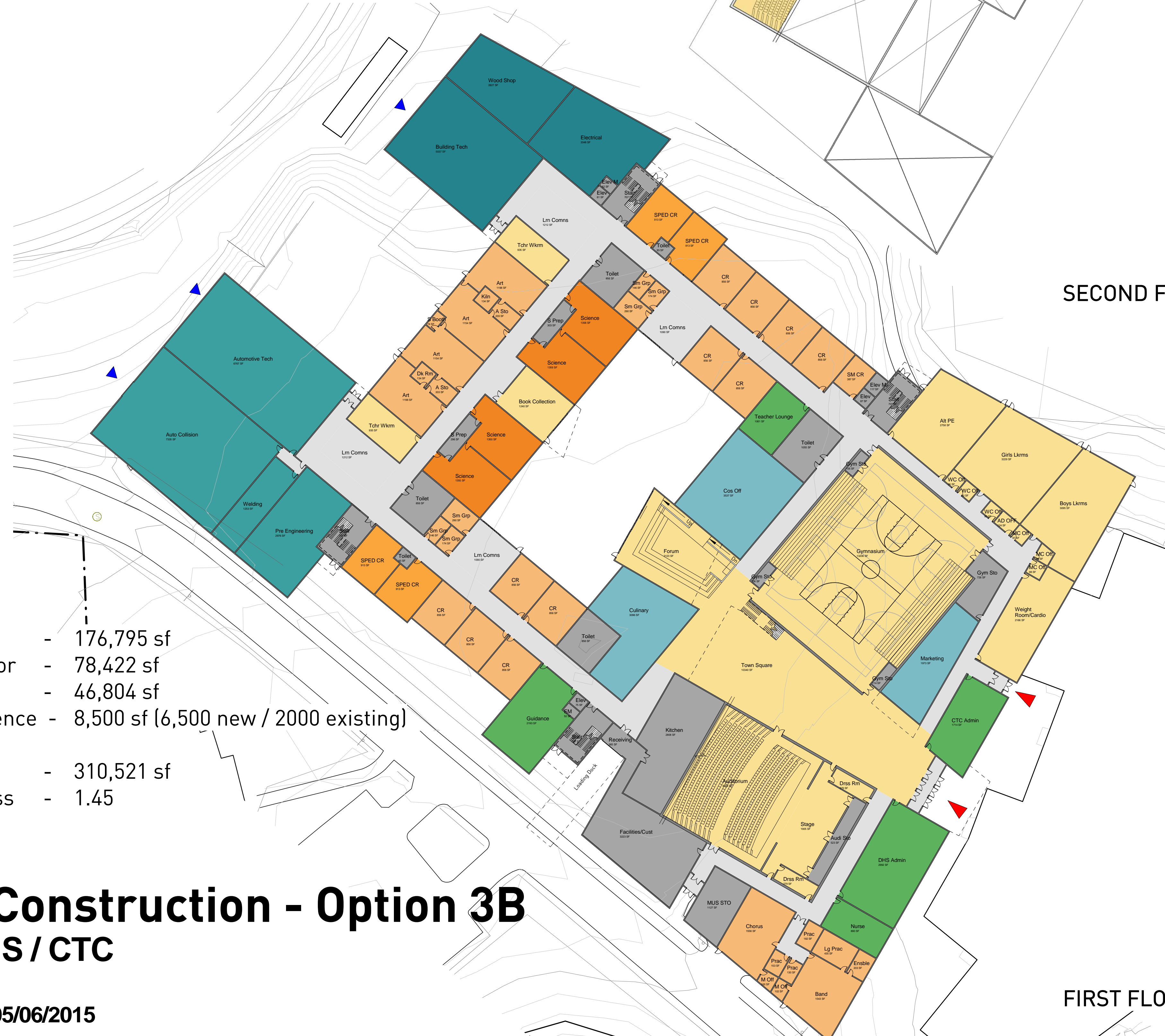

FIRST FLOOR

First Floor - 176,795 sf
 Second Floor - 78,422 sf
 Third Floor - 46,804 sf
 Animal Science - 8,500 sf (6,500 new / 2000 existing)

 Total - 310,521 sf
 Net To Gross - 1.45

COLOR LEGEND

■ Administration	■ Mechanical
■ Community / Shared	■ Storage
■ Classroom	■ Support
■ Special Education	■ Toilet Rooms
■ Science	■ Circulation
■ CTC Integrated	■ Learning Commons
■ CTC Public	
■ CTC Service	
■ CTC Stand Alone	

New Construction - Option 3B
Dover HS / CTC
 Dover, NH
 UPDATED 05/06/2015

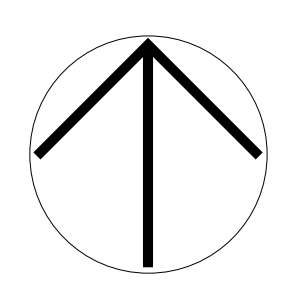

HMFH Architects Inc.

C:\Users\jwilliams\Documents\ZZ - Local Revit Files\Dover HS_CENTRAL_williams.rvt

New Construction Opt 3B Site Plan
Dover HS / CTC
Dover, NH
UPDATED 05/06/2015

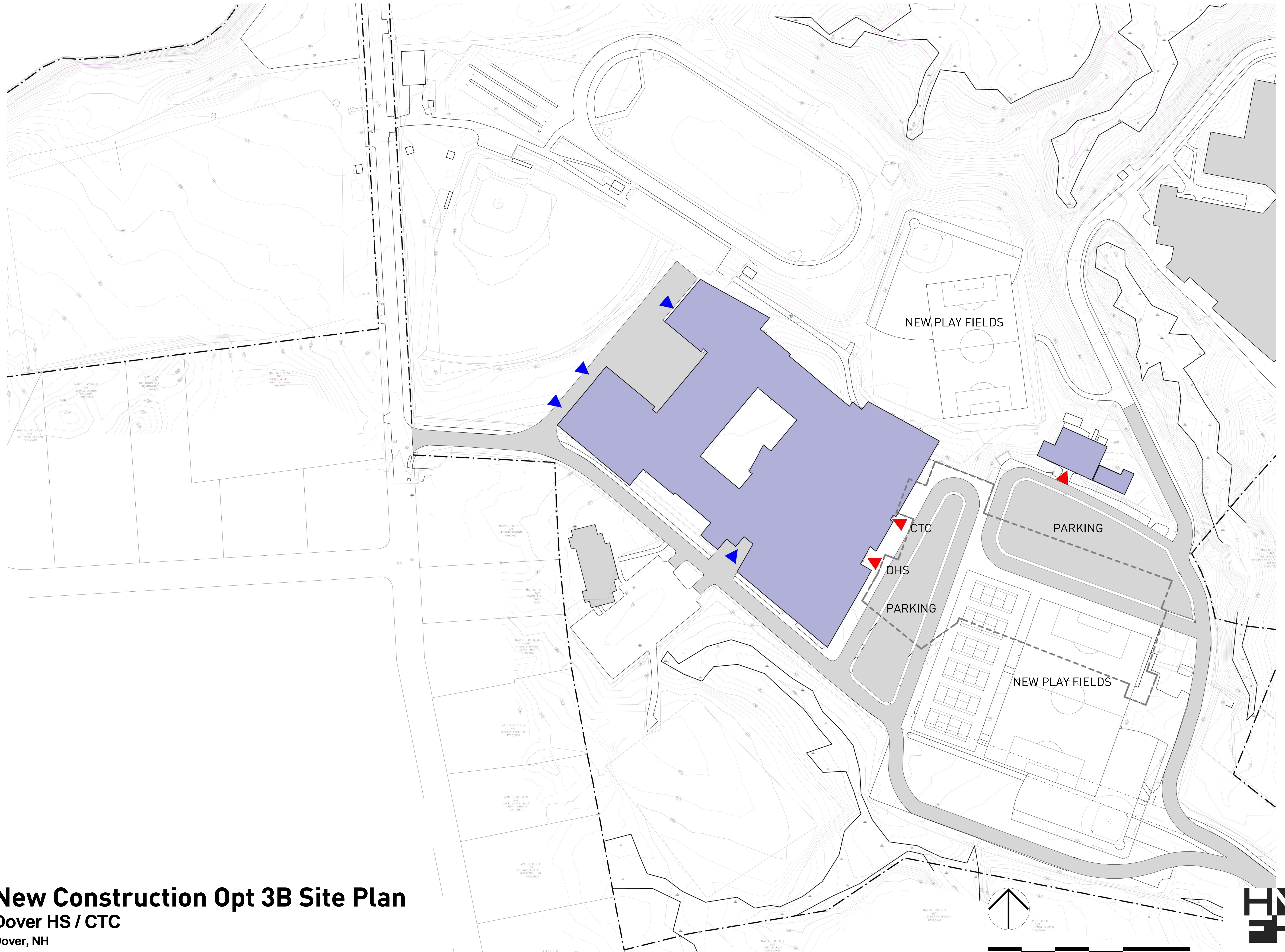

HMFH Architects Inc.

C:\Users\jw\Documents\22 - Local Revit File\Dover HS - CTC\22 - Local Revit File\Dover HS - CTC.rvt



THIRD FLOOR



SECOND FLOOR



FIRST FLOOR

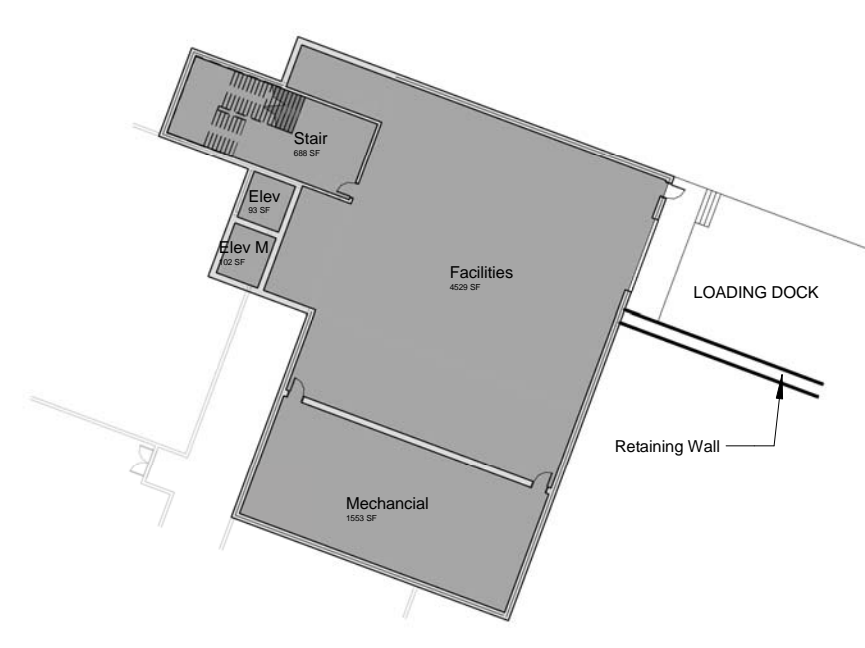

GROUND FLOOR

COLOR LEGEND

- Administration
- Community / Shared
- Classroom
- Special Education
- Science
- CTC Integrated
- CTC Public
- CTC Service
- CTC Stand Alone
- Mechanical
- Storage
- Support
- Toilet Rooms
- Circulation
- Learning Commons

Ground Floor - 7,664 sf
 First Floor - 146,204 sf
 Second Floor - 90,149 sf
 Third Floor - 49,219 sf
 Animal Science - 8,500 sf (6,500 new / 2000 existing)

Total - 300,072 sf
 Net To Gross - 1.40

New Construction - Option 3D

Dover HS / CTC

Dover, NH

UPDATED 05/06/2015

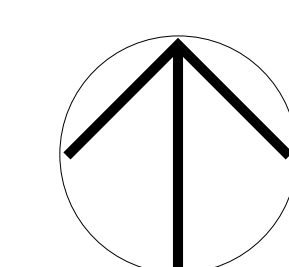

HMFH Architects Inc.

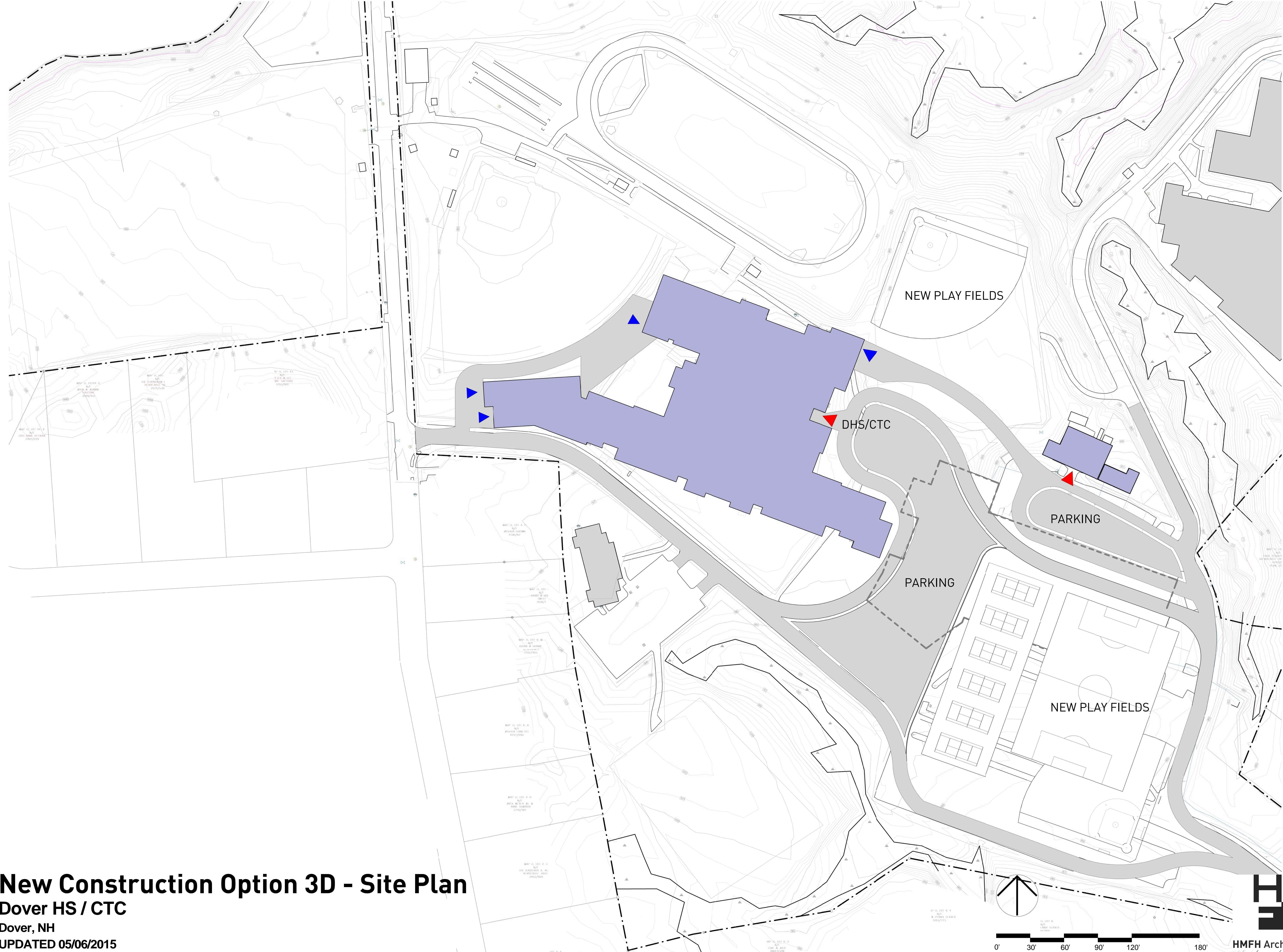

New Construction Option 3D - Site Plan
Dover HS / CTC
Dover, NH
UPDATED 05/06/2015



C:\Users\jw\Documents\02 - Local Revit File\Dover HS_CTRIAL.ctb